

# PRODUCT RANGE - 90(s)

## aquatherm ELBOW 90° (MOLDED, SOCKET)

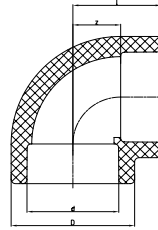

Part no.	Dimension (ND — OD)	d	z	l	D	Weight [lb]
		[in]	[in]	[in]	[in]	
0112108	½" — 20 mm	0.79	0.43	1.00	1.16	0.04
0112110	¾" — 25 mm	0.98	0.53	1.16	1.34	0.05
0112112	1" — 32 mm	1.26	0.67	1.38	1.69	0.09
0112114	1 ¼" — 40 mm	1.57	0.83	1.63	2.05	0.17
0112116	1 ½" — 50 mm	1.97	1.02	1.95	2.68	0.36
0112118	2" — 63 mm	2.48	1.28	2.36	3.31	0.65
0112120	2 ½" — 75 mm	2.95	1.52	2.70	3.94	0.98
0112122	3" — 90 mm	3.54	1.81	3.11	4.72	1.61
0112124	3 ½" — 110 mm	4.33	2.20	3.66	5.79	2.85
0112126	4" — 125 mm	4.92	3.01	4.59	6.57	4.42

## aquatherm ELBOW 90° SR (SHORT RADIUS, MOLDED, BUTT-FUSION)

The length of some fittings may not accommodate all butt-fusion equipment. Verify the equipment to be used is compatible with the fittings when ordering.

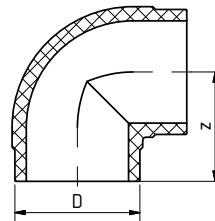

SDR	Part No.	Dimension (ND — OD)	D	z	Weight [lb]
			[in]	[in]	
17.6	2512130	6" — 160 mm	6.30	5.71	3.62
	2512134	8" — 200 mm	7.87	8.23	6.45
	2512138	10" — 250 mm	9.84	9.45	11.8
11	0112131	6" — 160 mm	6.30	5.71	5.65
	0112135	8" — 200 mm	7.87	8.23	9.26
	0112139	10" — 250 mm	9.84	9.45	16.9
9	0312130	6" — 160 mm	6.30	5.71	5.23
	0312134	8" — 200 mm	7.87	6.88	10.9
	0312138	10" — 250 mm	9.84	8.63	19.8
7.4	0112130	6" — 160 mm	6.30	5.71	5.65

## aquatherm STREET 90° female/male

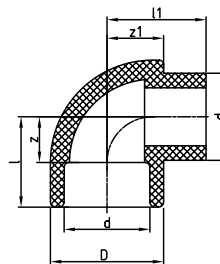

Part no.	Dimension (ND — OD)	d	z	l	D	l1	z1	Weight [lb]
		[in]	[in]	[in]	[in]	[in]	[in]	
0112308	½" — 20 mm	0.79	0.43	1.00	1.16	1.00	0.59	0.04
0112310	¾" — 25 mm	0.98	0.53	1.16	1.34	1.16	0.67	0.05
0112312	1" — 32 mm	1.26	0.67	1.38	1.69	1.54	0.85	0.10
0112314	1 ¼" — 40 mm	1.57	0.83	1.63	2.05	1.79	1.02	0.18